

# HEAVY DUTY THIMBLE

316 STAINLESS STEEL



Import



Stamped



Suncor  
Exclusive

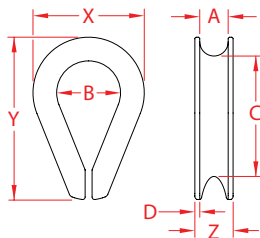

ITEM	A (size)	B	C	D	X (height)	Y (length)	Z (width)	WT (lb)	PACKAGING TYPE	EACH (qty)	INNER (qty)	CARTON (qty)	UPC
S0127-0005	3/16"	0.75"	1.46"	0.05"	1.07"	1.70"	0.38"	0.02	POLYBAG	1	10	500	791506032366
S0127-0007	1/4"	0.88"	1.71"	0.07"	1.48"	2.19"	0.44"	0.05	POLYBAG	1	10	400	791506032373
S0127-0008	5/16"	1.06"	1.97"	0.07"	1.73"	2.56"	0.55"	0.10	POLYBAG	1	10	200	791506032380
S0127-0010	3/8"	1.14"	2.25"	0.10"	2.05"	2.89"	0.77"	0.22	POLYBAG	1	10	100	791506032397
S0127-0012	7/16"	1.26"	2.50"	0.11"	2.16"	3.12"	0.76"	0.24	POLYBAG	1	1	100	791506032403
S0127-0013	1/2"	1.50"	2.92"	0.13"	2.71"	3.80"	0.88"	0.48	POLYBAG	1	1	50	791506032410
S0127-0014	9/16"	1.50"	2.92"	0.13"	2.64"	3.98"	0.95"	0.48	POLYBAG	1	1	50	791506032427
S0127-0016	5/8"	1.75"	3.41"	0.14"	2.95"	4.24"	1.10"	0.53	POLYBAG	1	1	40	791506032434
S0127-0020	3/4"	2.00"	3.98"	0.15"	3.45"	5.01"	1.34"	0.83	POLYBAG	1	1	25	791506032441
S0127-0022	7/8"	2.24"	4.48"	0.22"	4.12"	5.45"	1.72"	1.78	POLYBAG	1	1	10	791506032458
S0127-0025	1"	2.50"	4.72"	0.22"	4.70"	6.08"	1.73"	2.34	POLYBAG	1	1	10	791506032465
S0127-0032	1-1/8"-1-1/4"	2.88"	5.34"	0.22"	5.40"	7.25"	2.13"	3.37	POLYBAG	1	1	5	791506032472

**NOTE:**  
**HEAVY DUTY VERSION.**  
**ALL DIMENSIONS ARE NOMINAL (+/- 3%) AND ARE SUBJECT TO CHANGE WITHOUT NOTICE.**